

Sliding Door Closer DSC-CWV / CV series

For lightweight doors
Incline type

Versatile Model for Lightweight Sliding Doors

Cost-effective set products suitable for wooden and steel sliding doors

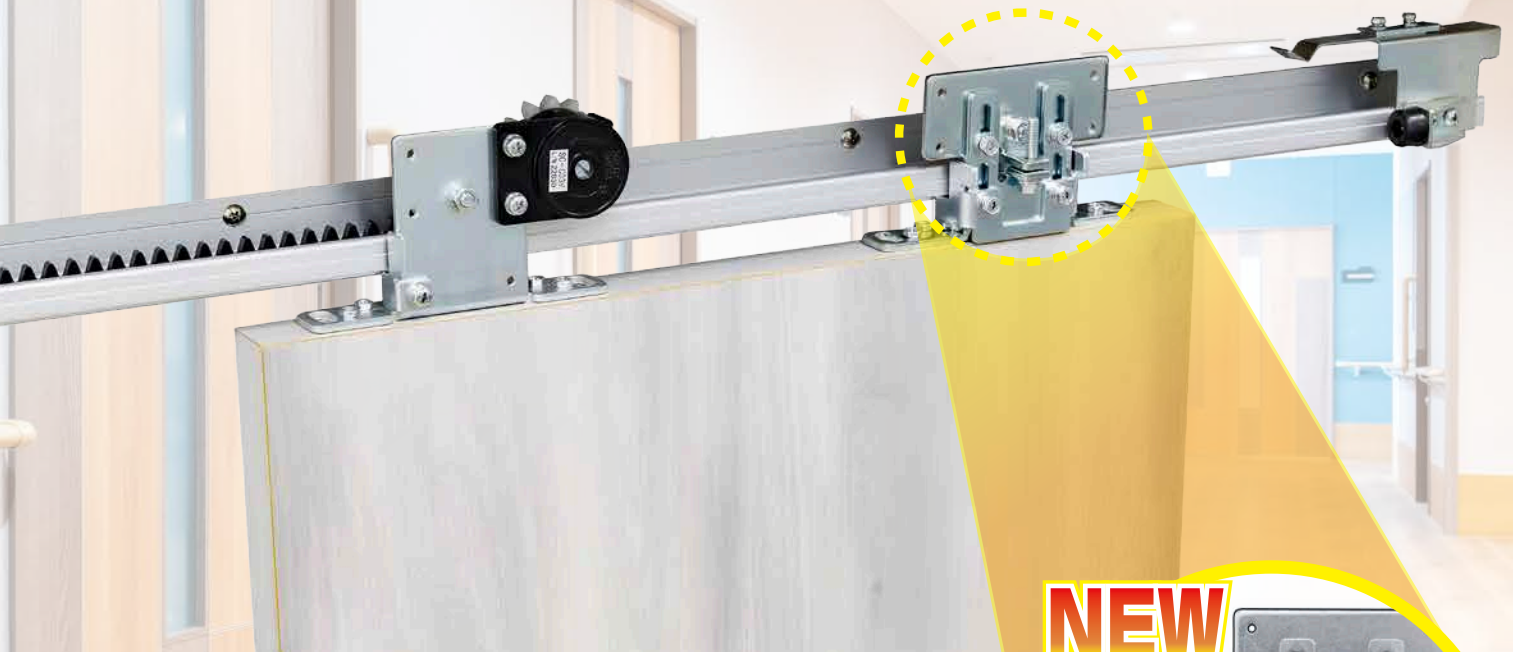

Features

- All parts required for inclining installation on wooden doors are included as standard.
[Incline type CWV series]
Guide rail, guide roller, stop device are included as standard, etc.
[Incline type CV series]
Stop device is included as standard.
- Equipped with an inclination adjustment mechanism.
- The product can be used for both left and right hand sliding doors and can be easily converted between left and right through a simple adjustment procedure.

Applications

General housing, hospitals, schools, wellness centers, etc.

NEW

Adjustment range
16mm

Equipped with
an inclination
adjustment
mechanism

 YouTube



User-friendly and cost-effective set products suitable for wooden sliding doors.

Features

- All parts required for inclining installation on wooden doors (e.g. guide rail, guide roller, stop device, etc.) are included as standard.
- The product can be used for both left and right hand sliding doors and can be easily converted between left and right through a simple adjustment procedure.



Specifications

For both right and left hand opening doors

Model		DSC-CW30V-22	DSC-CW30V-31	DSC-CW60V-22	DSC-CW60V-31
Applicable door	Weight [kg]	10 to 30			30 to 60
	Width [mm]	600 to 1200	1200 to 1600	600 to 1200	1200 to 1600
Max. stroke [mm]		1500			
Closing drive system		Rail inclination (3.5/300)			
Braking system		Fluid friction resistance type			
Braking time		7 to 11 seconds (for a door-opening distance of 900 mm)			
Initial opening force [N]		2.3 (Door weight 10 kg), 6.1 (Door weight 30 kg)		6.1 (Door weight 30 kg), 11.6 (Door weight 60 kg)	
Durability		More than half a million open/close operations			
Braking device		SC-C03V		SC-C06V	
Standard rail length [m]		2.2	3.1	2.2	3.1
Standard guide rail length [m]		1.3	1.6	1.3	1.6

Part details

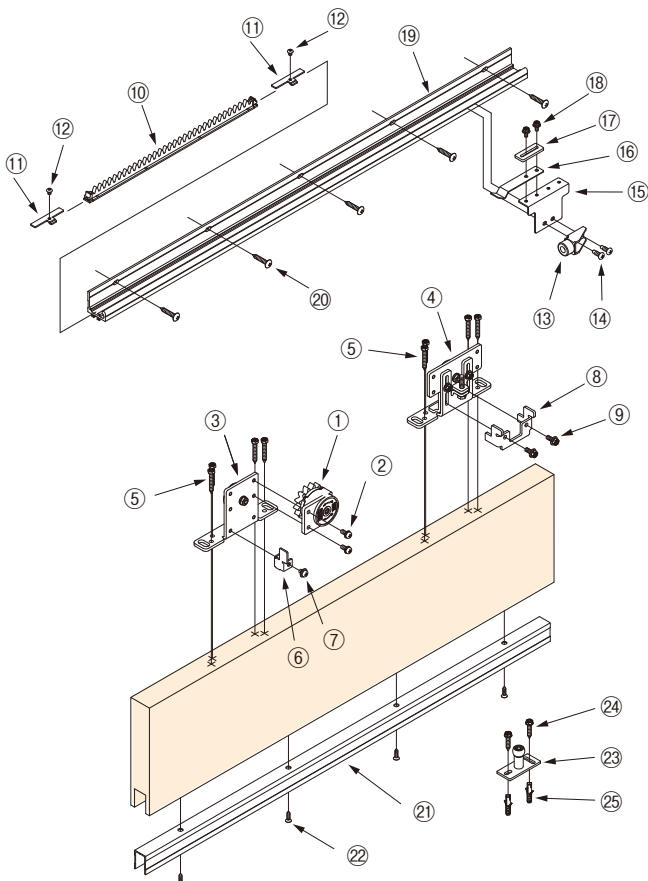

No.	Part name	Q'ty	Remarks
①	Braking device	1	
②	Pan head screw M5×12	2	For braking device
③	Hanger	1	
④	Hanger AJ (with height adjustment function)	1	For hanger
⑤	Cross recessed hex head tapping screw 5×35	8	
⑥	Door slip prevention bracket L (right-hand opening type)*	1	For door slip prevention bracket
	Door slip prevention bracket R (left-hand opening type)*	1	
⑦	Pan head screw M5×8	1	
⑧	Door slip prevention bracket AJ	1	
⑨	Cross recessed hex head screw M5×14	2	
⑩	Braking rack	1	
⑪	Braking rack bracket	2	For braking rack
⑫	Hex socket button head screw M4×5	2	
⑬	Door stopper	1	For door stopper
⑭	Pan head drill screw $\phi 5 \times 16$	2	
⑮	Plate spring bracket	1	
⑯	Plate spring	1	For stop device
⑰	Stop force adjustment plate	1	
⑱	Rail L=2200 [L=3100]	1	For rail
⑳	Truss head tapping screw $\phi 5 \times 30$	8[11]	
㉑	Guide rail L=1300 [L=1600]	1	For guide rail
㉒	Countersunk head tapping screw $\phi 4 \times 16$	4[5]	
㉓	Guide roller $\phi 16$	1	
㉔	Cross recessed hex head tapping screw 5×25	2	For guide roller
㉕	Hex head screw M5×12	2	
㉖	Fischer plug 6×30	2	

[] contains the quantity for a rail length of L = 3100 mm

*Use either the L or R bracket according to the opening direction.

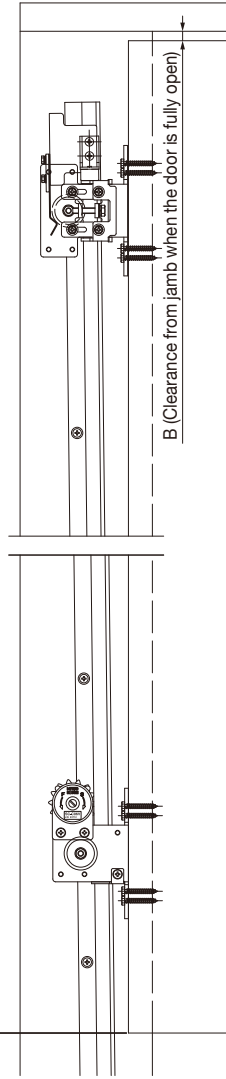
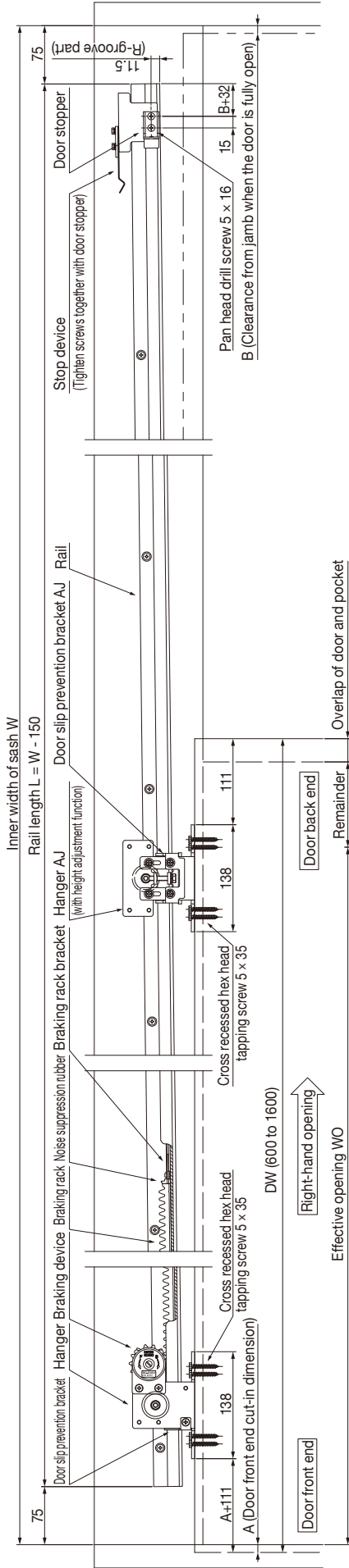

Installation diagrams for bi-parting use (meeting part)

*Door stoppers are required on the front ends of each door. (2 pcs total)

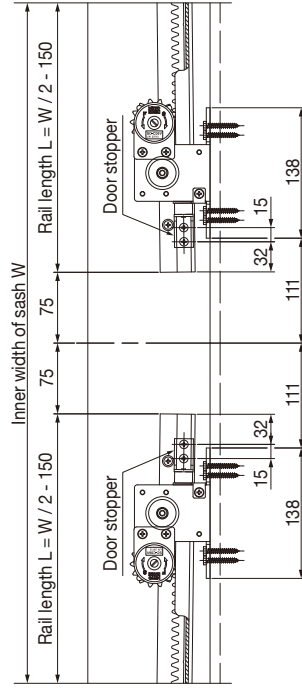

Frame side hole position diagram (as viewed from the inspection panel)

*For steel frames, make M5 (P = 0.8) tapped holes.

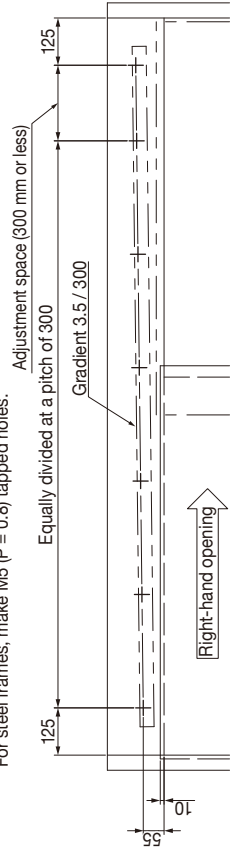

Cross section (Scale 1:2)

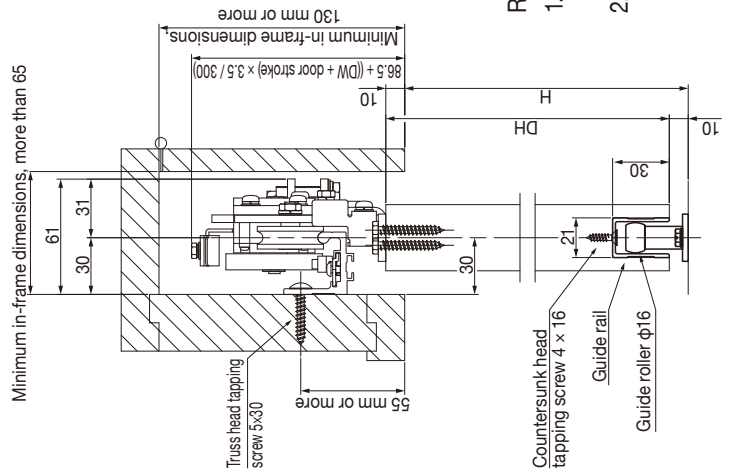

Remarks

- The diagrams show a right-hand opening type. The left-hand opening type is symmetrical to these diagrams.
- Door orientation is as follows:
As viewed from the inspection panel:
Opens to the left → Left-hand opening
Opens to the right → Right-hand opening

User-friendly and cost-effective set products suitable for steel sliding doors.

Features

- All parts required for inclining installation on steel doors (e.g. stop device, etc.) are included as standard.
- The product can be used for both left and right hand sliding doors and can be easily converted between left and right through a simple adjustment procedure.



Specifications

For both right and left hand opening doors

Model		DSC-C30V-22	DSC-C30V-31	DSC-C60V-22	DSC-C60V-31
Applicable door	Weight [kg]	10 to 30			30 to 60
	Width [mm]	600 to 1200	1200 to 1600	600 to 1200	1200 to 1600
Max. stroke [mm]		1500			
Closing drive system		Rail inclination (3.5/300)			
Braking system		Fluid friction resistance type			
Braking time		7 to 11 seconds (for a door-opening distance of 900 mm)			
Initial opening force [N]		2.3 (Door weight 10 kg), 6.1 (Door weight 30 kg)		6.1 (Door weight 30 kg), 11.6 (Door weight 60 kg)	
Durability		More than half a million open/close operations			
Braking device		SC-C03V		SC-C06V	
Standard rail length [m]		2.2	3.1	2.2	3.1

Part details

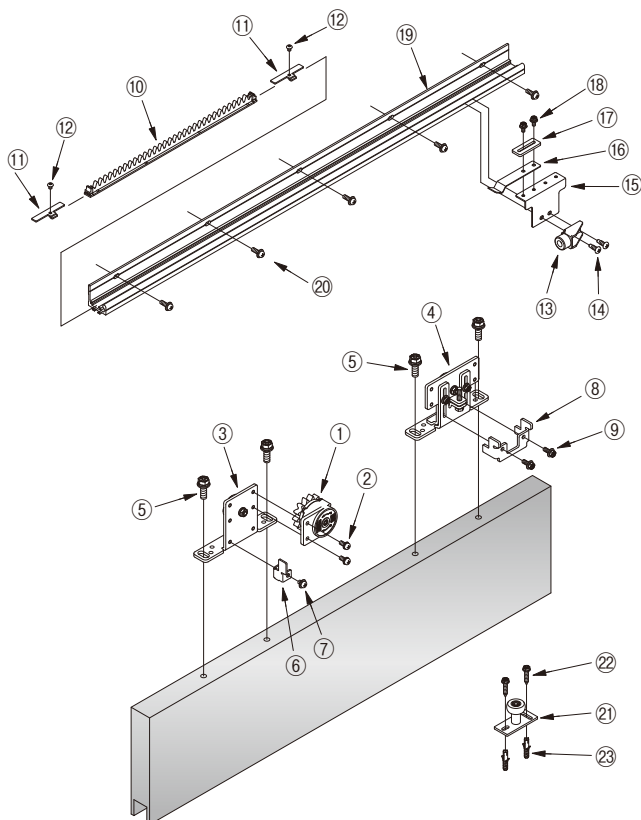

No.	Part name	Q'ty	Remarks
①	Braking device	1	For braking device
②	Pan head screw M5×12	2	
③	Hanger	1	For hanger
④	Hanger AJ (with height adjustment function)	1	
⑤	Cross recessed hex head screw M8×25	4	For door slip prevention bracket
⑥	Door slip prevention bracket L (right-hand opening type)*	1	
	Door slip prevention bracket R (left-hand opening type)*	1	
⑦	Pan head screw M5×8	1	
⑧	Door slip prevention bracket AJ	1	For braking rack
⑨	Cross recessed hex head screw M5×14	2	
⑩	Braking rack (with noise suppression rubber)	1	
⑪	Braking rack bracket	2	
⑫	Hex socket button head screw M4×5	2	For door stopper
⑬	Door stopper	1	
⑭	Pan head drill screw 5×16	2	For stop device
⑮	Plate spring bracket	1	
⑯	Plate spring	1	
⑰	Stop force adjustment plate	1	
⑱	Cross recessed hex head screw M4×10	2	For rail
⑲	Rail L=2200 [3100]	1	
⑳	Pan head screw M5×16	8[11]	For guide roller Option
㉑	Guide roller φ16	1	
㉒	Cross recessed hex head tapping screw 5×25 (For wood or fischer plug)	2	
	Cross recessed hex head screw M5×12 (For steel)	2	
㉓	Fischer plug 6×30 (For concrete or mortar)	2	

[] contains the quantity for a rail length of L = 3100 mm

*Use either the L or R bracket according to the opening direction.

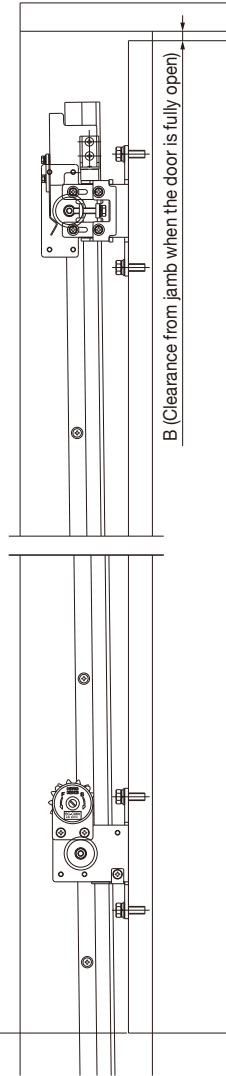
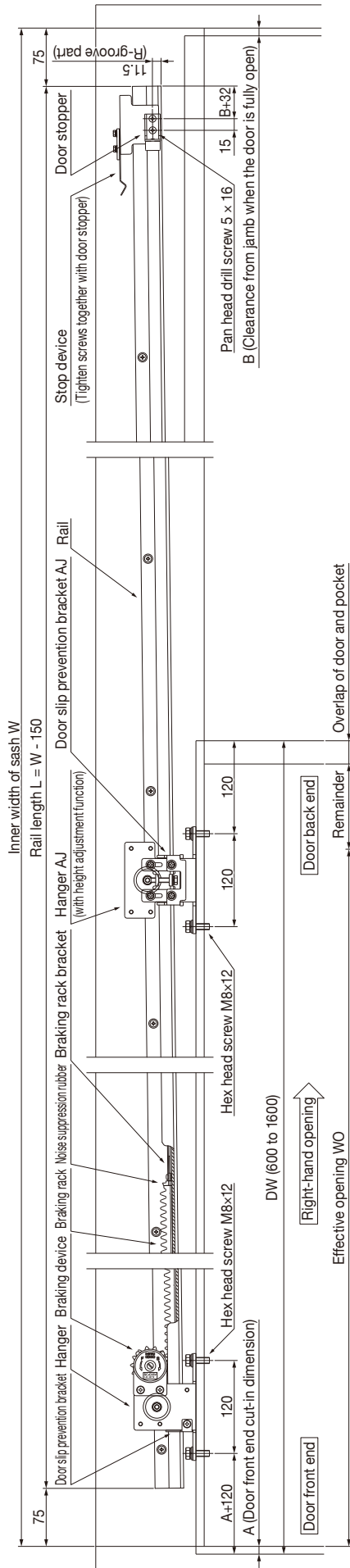

Installation diagrams for bi-parting use (meeting part)

*Door stoppers are required on the front ends of each door. (2 pcs total)

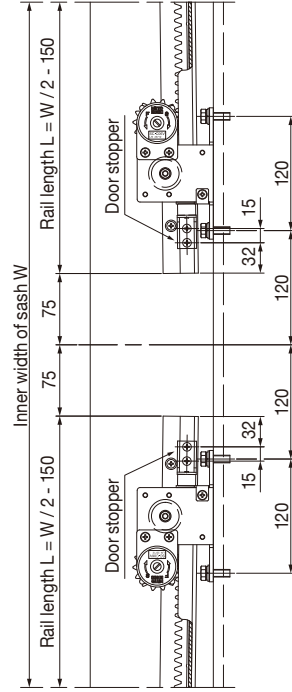

Cross section (Scale 1:2)

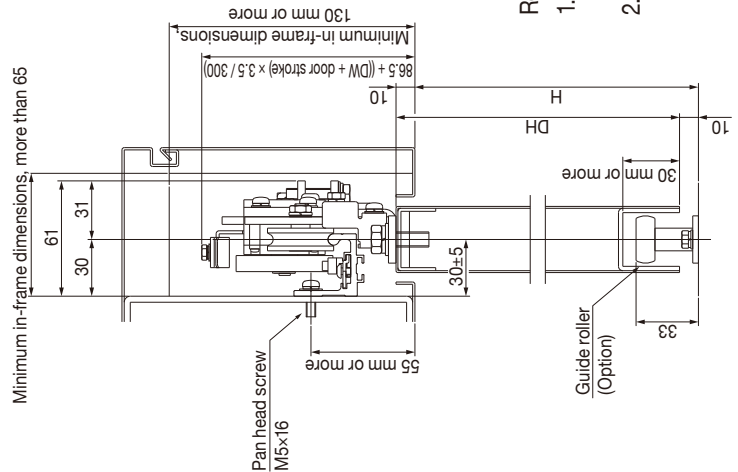

Remarks

- The diagrams show a right-hand opening type. The left-hand opening type is symmetrical to these diagrams.
- Door orientation is as follows:
 Opens to the left → Left-hand opening
 Opens to the right → Right-hand opening

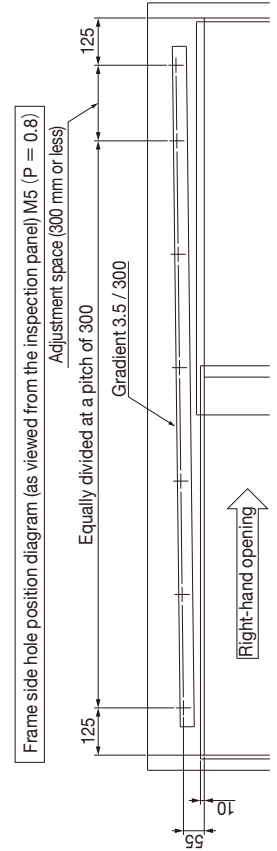

Braking device (SC-C03 / SC-C08)

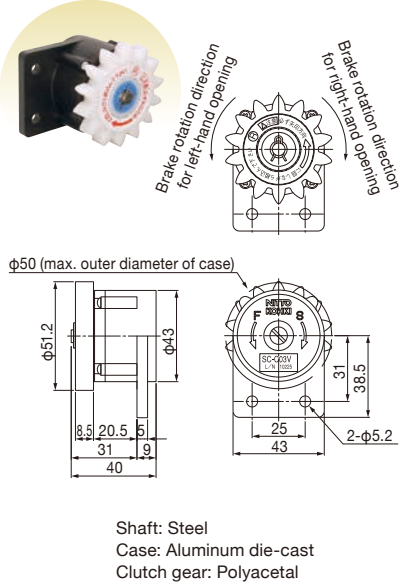

Hanger

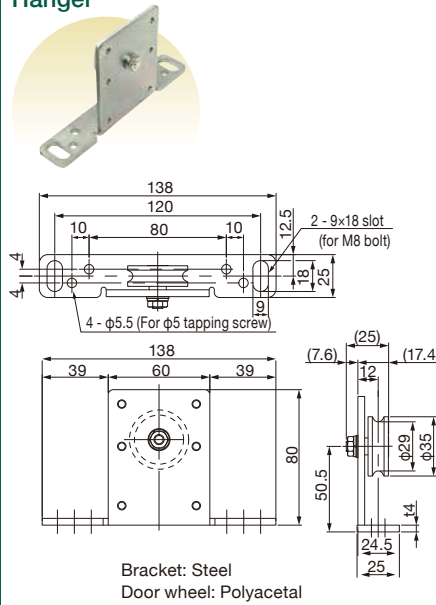

Hanger AJ

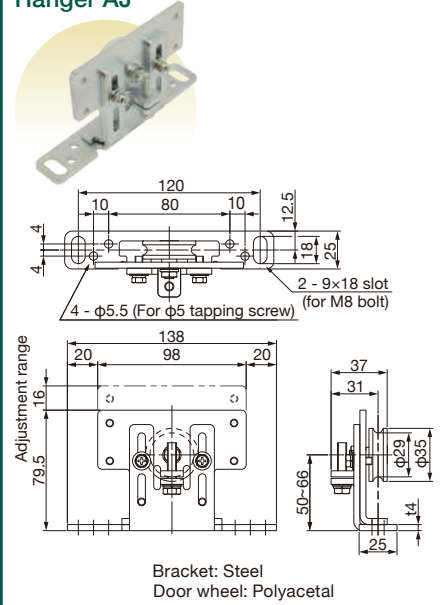

Door slip prevention bracket L / R

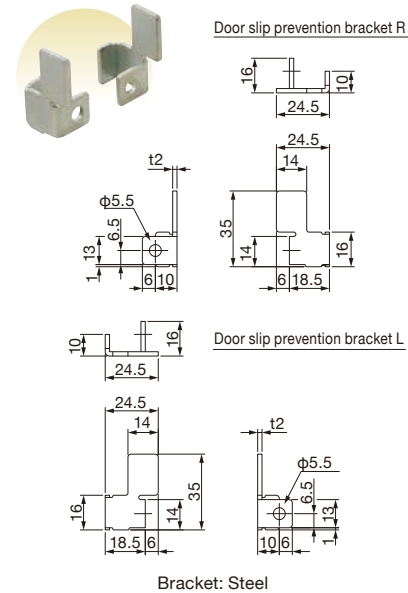

Door slip prevention bracket AJ

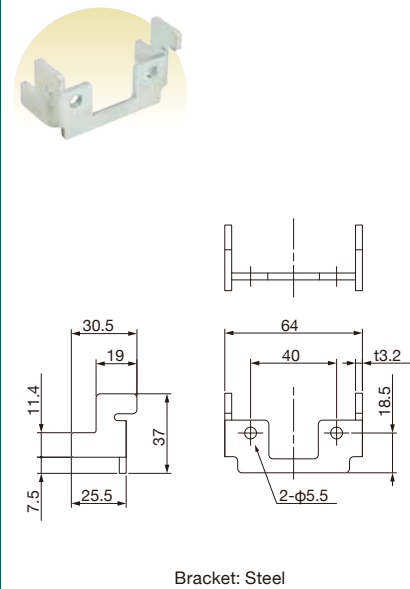

Braking rack

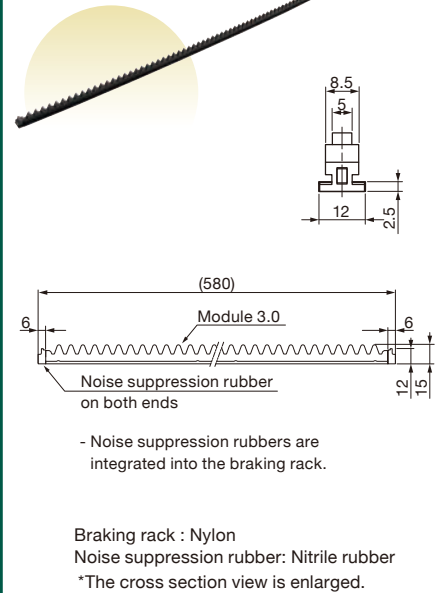

Braking rack bracket

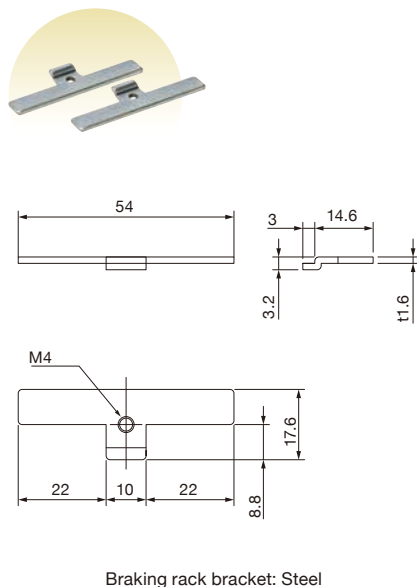

Stop device

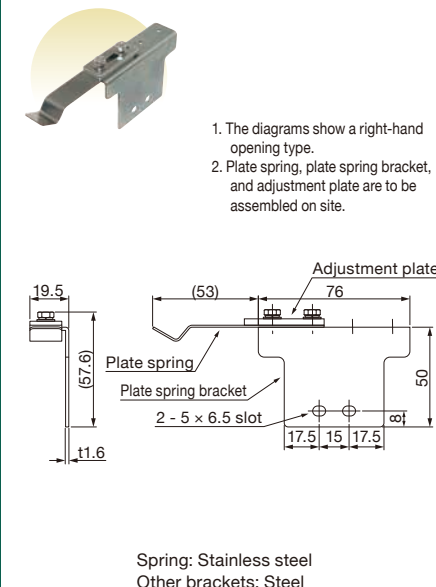

Door stopper

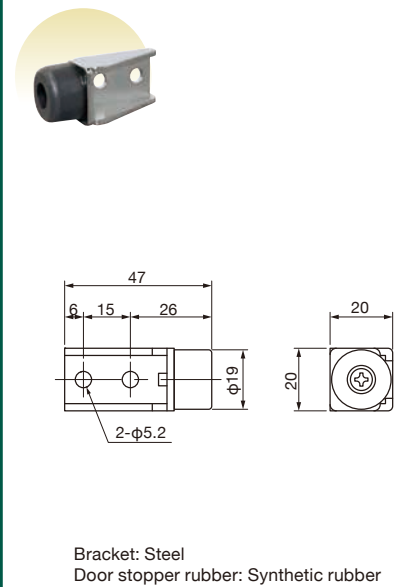

<p>Rail</p> <p>Rail: Aluminum extrusion (anodized finish) *The cross section view is enlarged.</p>	<p>Guide rail</p> <p>Guide rail: Aluminum extrusion (anodized finish) *The cross section view is enlarged.</p>	<p>Guide roller</p> <p>CWV series: $\phi 16$ guide roller is included as standard. CV series: Guide roller is an option.</p> <table border="1"> <tr> <td colspan="4">Guide rollers are available in 4 different diameters.</td> </tr> <tr> <td>$\phi 16$</td> <td>$\phi 25$</td> <td>$\phi 30$</td> <td>$\phi 35$</td> </tr> </table> <p>Plate: Stainless steel Roller: Polyacetal</p>	Guide rollers are available in 4 different diameters.				$\phi 16$	$\phi 25$	$\phi 30$	$\phi 35$
Guide rollers are available in 4 different diameters.										
$\phi 16$	$\phi 25$	$\phi 30$	$\phi 35$							

Option

Option	Function
Free Stop Device	This option allows the door to stop and hold at any desired position. To release the hold, lightly pull the door in the closing direction, and it will automatically close.
Delayed Action Device	The timing of the door closing from the fully open position can be delayed, allowing the elderly, persons with disabilities or people carrying cargo to pass through the door safely.
Close Assist Device	This option catches the door 25 mm before the fully-closed position and firmly pulls it closed. Useful for situations when the door's electric lock has a tight latch or airtight seals are causing friction when the door is being closed.
Back Check Device	This option reduces noise, shock, and vibration when the door is opened suddenly.
Single-action Double-sliding system	Two sliding doors can be opened and closed in conjunction. A wide effective opening can be obtained even when there is little space for a door pocket.
Bi-parting System	Opening one side of the doors will also open the other door.

◆Applicability Chart for Options and Sliding Door Closers

Base model	Option					
	Free Stop Device*	Delayed Action Device*	Back Check Device*	Bi-parting System	Single-action Double-sliding system	Close Assist Device
DSC-CW30V	○	○	○	○	○	○
DSC-CW60V	○	○	○	○	○	○
DSC-C30V	○	○	○	○	○	○
DSC-C60V	○	○	○	○	○	○

* Only one of the following options can be used on one system. (Multiple options cannot be used together.)

Door Closer

NITTO KOHKI CO., LTD.

Web www.nitto-kohki.co.jp/e/

Head Office

2-9-4, Nakaikogami, Ota-ku, Tokyo 146-8555, Japan
Tel : +81-3-3755-1111 Fax : +81-3-3753-8791
E-mail : overseas@nitto-kohki.co.jp



DISTRIBUTED BY