

*Ideal for sanding and grinding in narrow spaces, recessed areas and on curved surfaces*

- Quick belt change
- Rear exhaust system



### BELTON-10

Model **B-10CL**

- Belt size 10 mm (W)

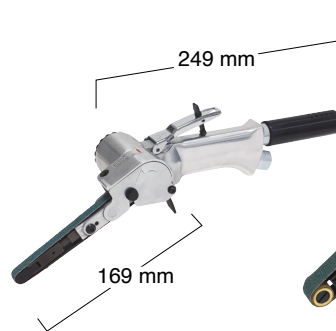

### BELTON-20

Model **B-20CL**

- Belt size 20 mm (W)

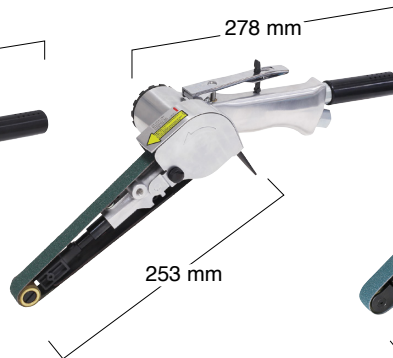

The Idle Pulley for B-20CL is supported on one side only.

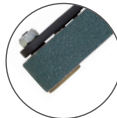

### BELTON-20

Model **B-20CL-A**

- Belt size 20 mm (W)

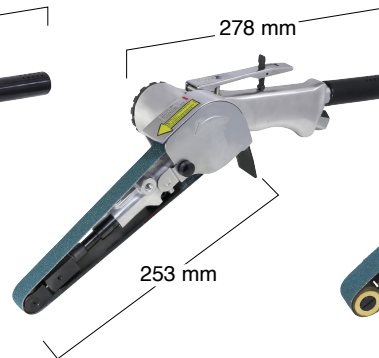

The Idle Pulley for B-20CL-A is supported on both sides.

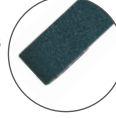

### BELTON-30

Model **B-30CL**

- Belt size 30 mm (W)

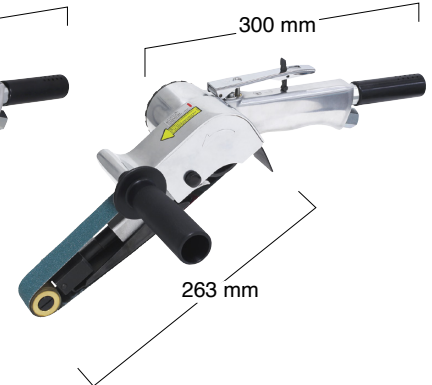

## Specifications

Model	B-10CL	B-20CL	B-20CL-A	B-30CL
Air Pressure	MPa (kgf/cm <sup>2</sup> )		0.6 (6)	
Air Consumption (No-load)	m <sup>3</sup> /min		0.48	
Free Speed	min <sup>-1</sup> (rpm)		18000	
Belt Speed	m/min		2770	
Belt Size	mm		20 x 520	
Air Inlet Size			Rc 1/4	
Mass (Weight)	kg		1.5	
Installed Abrasive Belt	Z#60 x 10 mm		Z#60 x 20 mm	
Accessories Included	<ul style="list-style-type: none"> <li>• 2 pieces of Abrasive Belt Z#60 x 10 mm (1 piece installed)</li> <li>• Abrasive Belt Z#80 x 10 mm</li> <li>• Abrasive Belt Z#100 x 10 mm</li> <li>• Abrasive Belt Z#120 x 10 mm</li> <li>• 1.5 mm Hex. Socket Screw Key</li> <li>• 4 mm Hex. Socket Screw Key</li> <li>• Bushing R 1/4 x NPT 1/4</li> </ul>		<ul style="list-style-type: none"> <li>• 2 pieces of Abrasive Belt Z#60 x 20 mm (1 piece installed)</li> <li>• Abrasive Belt Z#80 x 20 mm</li> <li>• Abrasive Belt Z#100 x 20 mm</li> <li>• Abrasive Belt Z#120 x 20 mm</li> <li>• 2.5 mm Hex. Socket Screw Key</li> <li>• 4 mm Hex. Socket Screw Key</li> <li>• Bushing R 1/4 x NPT 1/4</li> <li>• Convex Shoe</li> </ul>	
			<ul style="list-style-type: none"> <li>• 2 pieces of Abrasive Belt Z#60 x 30 mm (1 piece installed)</li> <li>• Abrasive Belt Z#80 x 30 mm</li> <li>• Abrasive Belt Z#100 x 30 mm</li> <li>• 5 mm Hex. Socket Screw Key</li> <li>• Handle Ass'y</li> <li>• Bushing R 1/4 x NPT 1/4</li> </ul>	

## Easy belt change

Abrasive belt can be changed easily. \*Rotate and open the cover when changing.

### Self-locking

Push the idle pulley into self-lock position to loosen the belt.

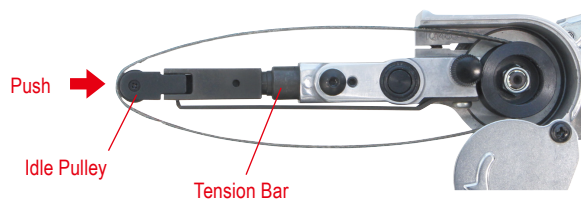

For all models

### Unlock

Press the push button to pull back the tension bar.

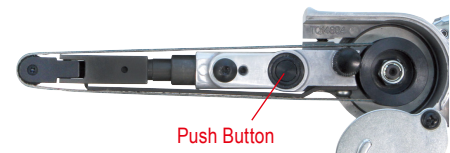

10/20 Type

Press the shoe in the direction of the arrow.

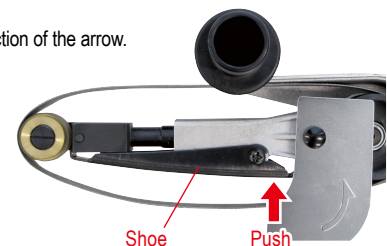

30 Type