

# PURGE ADAPTER PAD Series

***Ideal for eliminating residual pressure in piping***



YouTube

*Couplings can be connected smoothly*

PAD-2  
Type

Improved  
residual pressure  
release speed

**UP!!**

PAD-FM  
Type

***Slim and  
neat piping***

with  
an in-line design

Note: CUPLA, tee joints and hoses are not included. Please prepare them separately.

# Simple one-push operation

PAD-2  
Type

Purge residual  
pressure

Can be operated with a screwdriver  
if the button is stiff.

Insert an ordinary flat head screwdriver  
into the groove in the Valve Holder and  
press the button by leverage.

Operate the button  
by leverage

Purge residual  
pressure

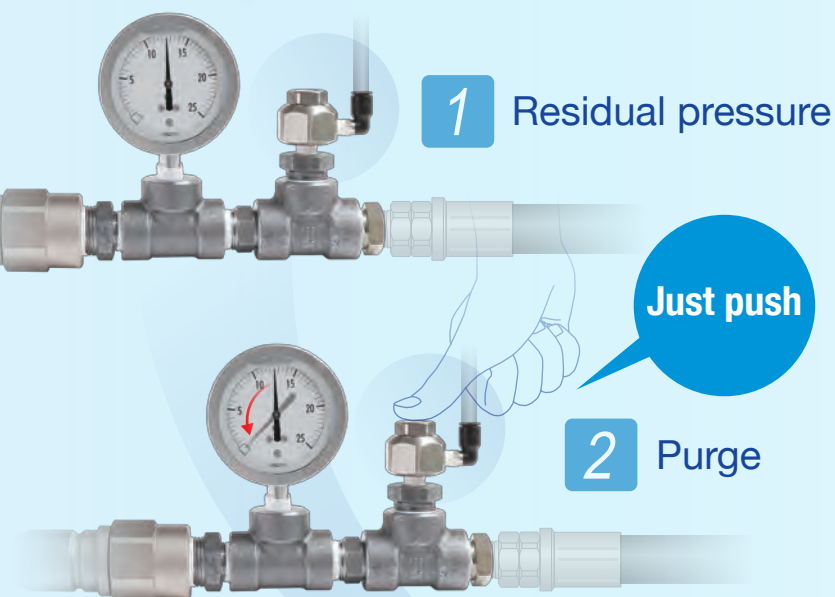

## How Residual Pressure is Eliminated

While the button is pressed, hydraulic oil is discharged from the drain outlet port and the residual pressure is eliminated. When the button is released, it returns to its original position and the discharge of hydraulic oil stops.

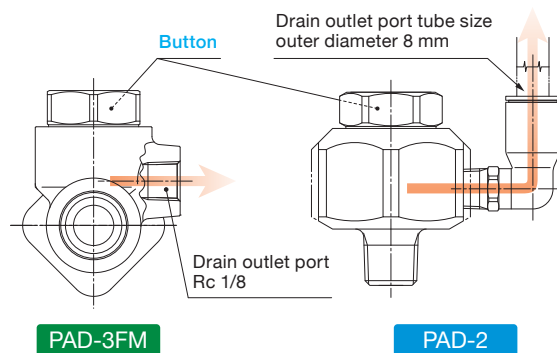

Eliminates residual pressure  
instantly

3 Complete



## Residual Pressure Purge Speed Comparison

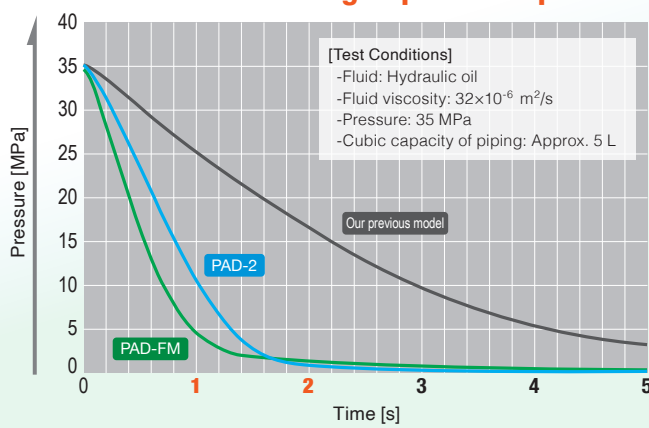

Our previous model

PAD-2

PAD-FM

Tube fitting included.

Tube fittings are not included.

For size (thread) of  
**3/8 or larger**

PAD-FM  
In-line Type

Purge Adapter **PAD**  
PURGE ADAPTER SERIES  
PAD-2/PAD-3FM/PAD-4FM/PAD-6FM/PAD-8FM

Installation example:  
with our product 350 CUPLA

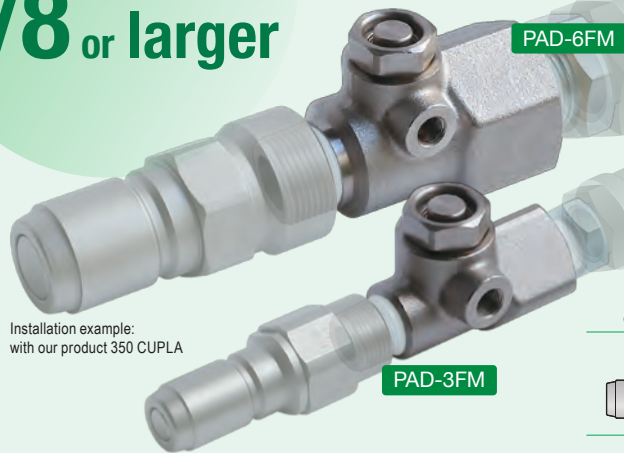

Slim and neat piping

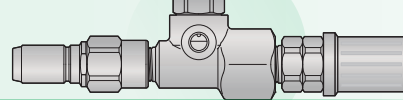

Just push



Purge residual pressure

Note: CUPLA, hoses and tube fittings are not included. Please prepare them separately.

## Models and Dimensions

WAF : WAF stands for width across flats.

### PAD-2 Female thread

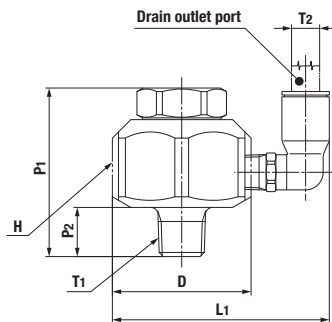

Model	Mass (g)	Dimensions (mm)						
		L1	φD	P1	P2	H (WAF)	T1	φT2
PAD-2	235	(62)	39.5	(48)	14	Hex.36	R 1/4	8

### PAD-3FM / PAD-4FM For thread connection

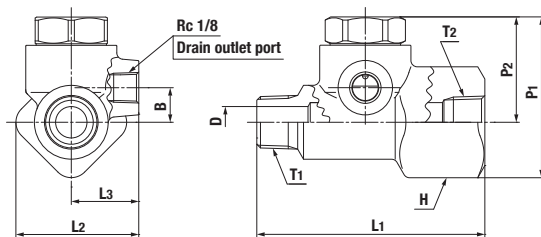

Model	Mass (g)	Dimensions (mm)									
		L1	L2	L3	B	φD	P1	P2	H (WAF)	T1	T2
PAD-3FM	320	72.5	(39)	21.5	(11)	10	(51)	(33.5)	□29	R 3/8	Rc 3/8
PAD-4FM	307	72.5	(39)	21.5	(11)	12.5	(51)	(33.5)	□29	R 1/2	Rc 1/2

### PAD-6FM / PAD-8FM For thread connection

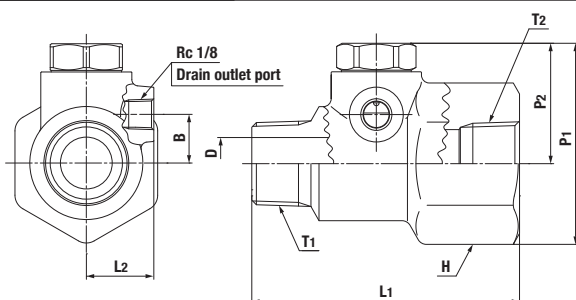

Model	Mass (g)	Dimensions (mm)									
		L1	L2	B	φD	P1	P2	H (WAF)	T1	T2	
PAD-6FM	665	86	21.5	(15.5)	16.5	(63.5)	(38)	Hex.46	R 3/4	Rc 3/4	
PAD-8FM	620	86	21.5	(15.5)	21.5	(63.5)	(38)	Hex.46	R 1	Rc 1	

## Specifications

Model	PAD-2	PAD-3FM	PAD-4FM	PAD-6FM	PAD-8FM
Body material	Steel (Nickel plated)				
Application	R 1/4	R 3/8 Rc 3/8	R 1/2 Rc 1/2	R 3/4 Rc 3/4	R 1 Rc 1
Pressure unit	MPa	kgf/cm <sup>2</sup>	bar	PSI	
Working pressure <sup>*1</sup>	35.0	357	350	5080	
Drain outlet port	For 8 mm OD tube	Application: Rc 1/8 (Max. Tightening Torque: 5 Nm)			
Applicable fluids	Hydraulic oil				
Seal material	Seal material	Mark	Working temperature range	Remarks	
Working temperature range <sup>*2</sup>	Nitrile rubber	NBR	-5°C to +80°C	Standard material	

\*1: The normal allowable fluid pressure under continuous use.

Exceeding the working pressure may cause damage and leakage.

\*2: The operable temperature range depends on the operating conditions.

## Maximum Tightening Torque

Nm {kgf·cm}

Size (Thread)	R 1/4	R 3/8 × Rc 3/8	R 1/2 × Rc 1/2	R 3/4 × Rc 3/4	R 1 × Rc 1
Torque	28 {286}	40 {408}	80 {816}	150 {1530}	250 {2550}

## Minimum Cross-Sectional Area

(mm<sup>2</sup>)

Model	PAD-2	PAD-3FM	PAD-4FM	PAD-6FM	PAD-8FM
Minimum Cross-Sectional Area	—	78.5 (φ10)	122 (φ12.5)	213 (φ16.5)	363 (φ21.5)

## Suitability for Vacuum

Not suitable for vacuum application.

## Safety Guide

Be sure to read the "Instruction for Purge Adapter".

### Warning

- Do not use the product for purposes other than residual pressure release. The operating pressure will fall when the button is pressed during use under pressure, and it may cause unexpected damage due to the apparatus malfunctioning.
- Do not use the Purge Adapter continuously exceeding the rated working pressure.
- Do not apply any artificial impact, bend or tension.
- Do not disassemble.

### Caution

- When the Purge Adapter is in high temperature state, wear protective equipment such as gloves, etc., and handle with extra care.
- Do not strike the upper part of the button. When the button is too tight to press, use a slotted screwdriver, hook it to the groove of the valve holder, and press the button using the principle of the lever.



# CUPLA with Built-in Residual Pressure Purge Function

## Connectable Under Residual Pressure

- Smooth connection even under residual pressure during connection.
- No need for residual pressure handling. Residual pressure is eliminated simply by connecting.

For high pressure and hydraulic piping

## HYPER HSP CUPLA

Standard

Working pressure  
**20.6 MPa**



Size (thread): 1/4", 3/8", 1/2", 3/4", 1"

For medium pressure

## SP CUPLA Type A PV Type

Made-to-order



Size (thread): 3/4", 1", 1 1/4", 1 1/2"

## Accessories for CUPLA

Semi-standard

## RESIDUAL PRESSURE RELEASE JIG ZN Series

Residual Pressure Release Jig for SP CUPLA Type A and HYDRAULIC CUPLA

### Eliminates residual pressure by connecting to CUPLA.

- Residual pressure within socket or plug can be released easily by just turning the handle.
- Residual pressure release jigs are available in two types; socket type for use with plugs and plug type for use with sockets.
- Connecting method to sockets or plugs is the same as that of standard CUPLA.

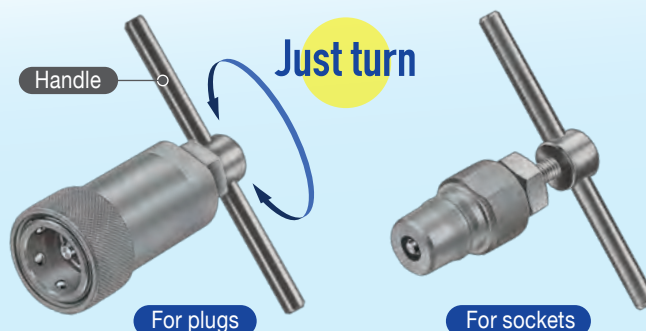

For more details on the above products, please refer to the separate "Quick Connect Couplings General Catalog."

**NITTO KOHKI CO., LTD.**

Web [www.nitto-kohki.co.jp/e/](http://www.nitto-kohki.co.jp/e/)

### Head Office

2-9-4, Nakaikegami, Ota-ku, Tokyo 146-8555, Japan  
Tel : +81-3-3755-1111 Fax : +81-3-3753-8791  
E-mail : [overseas@nitto-kohki.co.jp](mailto:overseas@nitto-kohki.co.jp)



DISTRIBUTED BY